



# GibbsCAM



Powerfully Simple. Simply Powerful.



Society of Manufacturing Engineers Phoenix Chapter 67 in association with SME International Presents the:

## *“Gibbs Cam & Mesa Community College Manufacturing Tour”*

*Don't miss your chance to see Mesa Community College and its evolving manufacturing programs. Enjoy a tour of the hands-on labs and a 30-minute presentation of GibbsCAM.*

**Directions:**

MCC is located between Longmore and Dobson, South of Southern in Mesa. Head North off of US 60 on Dobson and make an immediate right into the South parking lot. Park in Lot E, the TC Building is directly North of the parking lot, go to room TC 208.

Check out the Chapter 67 website @ <http://chapters.sme.org/067/>

- **Join Us At:**  
Room TC 208, located on the South East building TC 50  
Mesa Community College  
1833 West Southern Ave  
Mesa, AZ 85202
- **Date :** November 11<sup>th</sup> 2009
- **Time:** Sign In / Dinner: 5:30 p.m.  
Tour Starts @ 6:15 p.m.  
Subs, Chips, and Soda will be provided.
- **Cost:** \$5.00 for Adults, Seniors, & Students.  
Free if you choose not to eat!

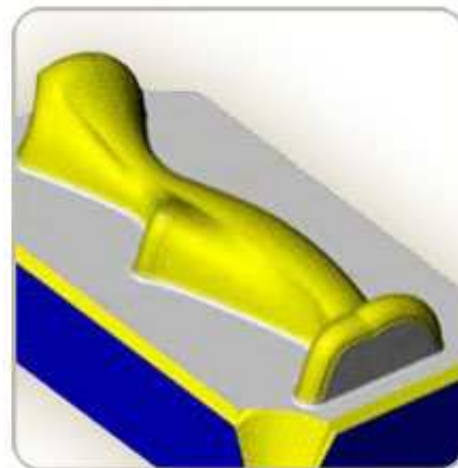

Contact Cable Morris @ 480-966-4451 and leave a message if you plan on attending. We need to have a total count of attendees.

**Upcoming events:**

### **The SME Annual Charity Golf Tournament!!**

Remember; the golf tournament is for a good cause, SME Chapter 67 Student Scholarships. We can always use raffle item donations, golfers, & sponsors. Please contact Cable Morris if you have any questions, (480)966-4451

[www.gibbscam.com](http://www.gibbscam.com)    [www.mc.maricopa.edu](http://www.mc.maricopa.edu)